

State of South Carolina

Pursuant to a Warrant from John Thomas Esq. Commissioner of Locations dated the 27th of Sept. 1784 I have admeasured and laid out unto Sarah Davidson a Tract of Land containing two Thousand Eighty Nine Acres Situate in Ninety Six District East of the Old Boundary on the Branches of Jacobs Creek and Broad Rivers - Bunches being 24<sup>th</sup> N.E. on Vacant Land & Clerks Land N.W. & W. on Land laid out for John Hamilton and Vacant Land S.E. on Hopes Land & that such shape & marks as the annexed Plat Represents Surveyed the 18<sup>th</sup> Oct. 1784

Recorded the 12<sup>th</sup> Jan<sup>y</sup> 1785 Geo. Salmon Esq

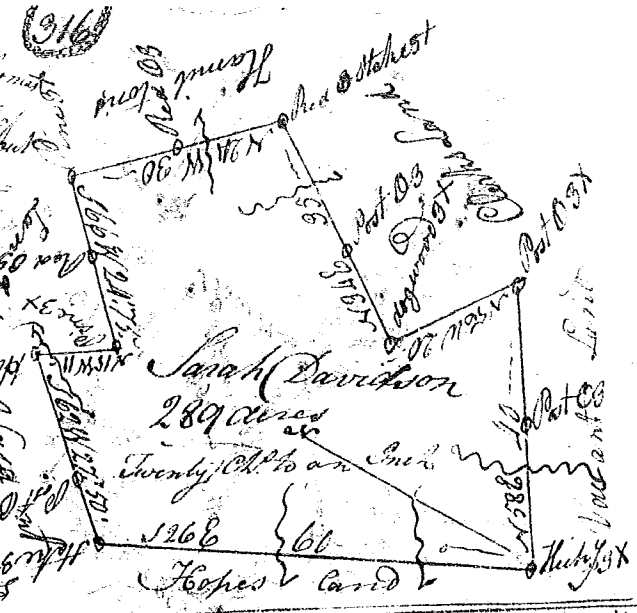

State of S. Carolina Pursuant to a Warrant from John Thomas Esq. Commissioner of Locations dated the 9<sup>th</sup> of Oct. 1784 I have admeasured & laid out unto William Shid a Tract of Land containing 256 Acres Situate in 96 District East of the Old Boundary on both sides of Jacobs Creek of the Old Boundary Bounding on all sides on Vacant Land and that such shape & marks as the annexed Plat Represents Surveyed the 25<sup>th</sup> Oct. 1784

Recorded the 12<sup>th</sup> Jan<sup>y</sup> 1785 Geo. Salmon Esq

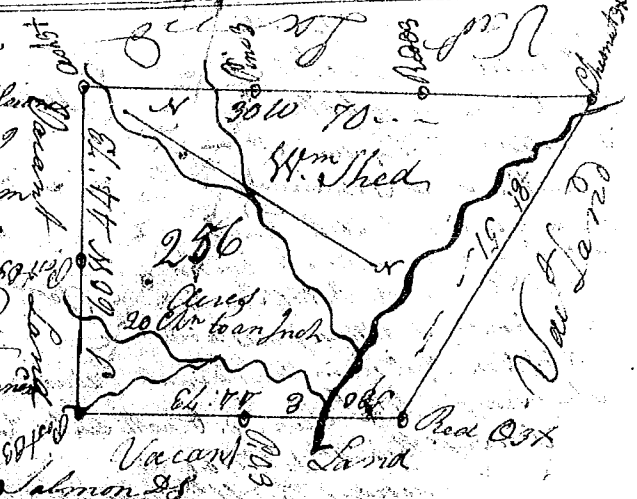

State of S. Carolina Pursuant to a Warrant from John Thomas Esq. Commissioner of Locations dated the 6<sup>th</sup> of Sept. 1784 I have admeasured and laid out unto Adam Thompson a Tract of Land containing two Thousand and Twenty four Acres Situate in Ninety Six District East of the Old Boundary on both sides of the blue Branch of the Jacobs Creek within of Broad River Bounding N.E. on Browns Land & Vac. Land S.W. on G. S. Farms Land S. on Lipscoms & Hopes Land all other sides Vacant. & that such shape & marks as the annexed Plat Represents Surveyed the 20<sup>th</sup> Oct. 1784

Recorded the 19<sup>th</sup> Jan<sup>y</sup> 1785 Geo. Salmon Esq



State of S. Carolina Pursuant to a Warrant from Geo. Thomas Esq. Commissioner of Locations dated the 11<sup>th</sup> of Sept. 1784 I have admeasured & laid out unto Tho. M'Grew a Tract of Land containing 100 Acres Situate in 96 District East of the Old Boundary on both sides of the Flat Creek of Broad River Bounding N.E. on the same Vac. & Hopes Land & that such shape & marks as the annexed Plat Represents Surveyed the 30<sup>th</sup> Oct. 1784

Recorded the 12<sup>th</sup> Jan<sup>y</sup> 1785 Geo. Salmon Esq

